

FOREST MANOR

CITY PARK

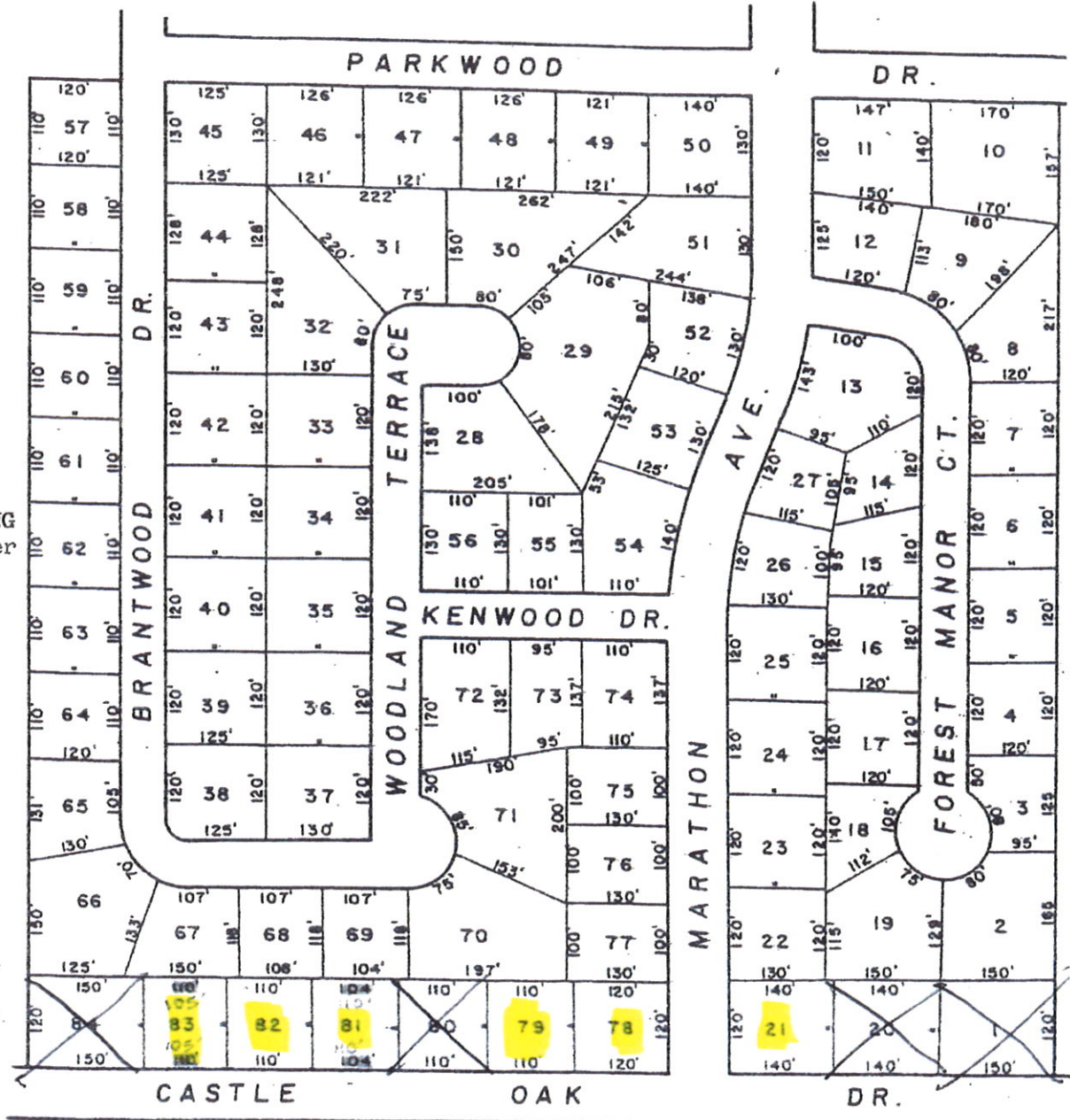

TODD L. SYRING
Property owner
Lot No. 62

See copy of the
"RECORDED PLAT"
for actual lot
dimensions.

KENNETH C. SYRING

Property Owner of Lots 1, 20, 21, 78, 79, 80, 81, 82, 83, & 84

RECEIVED & ACKNOWLEDGED
LJH DATE 5/15/14
DATE _____

CAUTION: THE ACCURACY OF THE INFORMATION CONTAINED HEREIN HAS NOT BEEN CONFIRMED AND IS PROVIDED FOR GENERAL INFORMATION PURPOSES ONLY. THE LOT SIZE, LOCATION OF BOUNDARIES, PLACEMENT OF IMPROVEMENTS (if any), EXISTENCE OF EASEMENTS, ELEVATIONS, ZONING, SOIL TYPE(S), OR OTHER FACTORS ABOUT THIS PROPERTY, SHOULD BE VERIFIED BY AN APPROPRIATE EXPERT (i.e. SURVEYOR, ENGINEER, ETC.) IF THEY ARE MATERIAL TO HOW YOU MAY USE THE PROPERTY.